

**FINAL
ALTERNATIVE ASSESSMENT**

(COVER PAGE)

Session : April 2020

Programme : Diploma in Electrical & Electronic Engineering (DEEI)
Diploma in Mechanical Engineering (DMEN)

Course : **EGR1185/EGR1175: Engineering Drawing**

Date of Examination : 8 August 2020 (Saturday)

Time : 12.00noon – 2.15pm Reading Time : Nil

Duration : 2 Hours 15 Minutes

Special Instructions :

This paper consists of **FOUR (4)** questions. **Answer all questions with the application of Autocad.**
All questions carry equal marks. All drawings are to be drawn in full size unless otherwise stated.
All dimensions are not required unless the question explicitly asks for them.

Material permitted : Non-Programmable Scientific Calculator

Materials provided : Nil

Examiner(s) : **Mr Phua Chin Lai**

Chief Moderator : Mr Tham Chan Seng

This paper consists of 5 printed pages, including the cover page

DIPLOMA IN MECHANICAL ENGINEERING PROGRAMME (DMEN)
 DIPLOMA IN ELECTRIC & ELECTRONIC ENGINEERING PROGRAMME (DEEI)
 EGR1175/EGR1185: ENGINEERING DRAWING
 FINAL ALTERNATIVE ASSESSMENT: APRIL 2020 SESSION

Instructions: This paper consists of **FOUR (4)** questions. **Answer all questions with the application of Autocad.** All questions carry equal marks. All drawings are to be drawn in full size unless otherwise stated. All dimensions are not required unless the question explicitly asks for them.

NOTE: All dimensions are given in mm.

Question 1

Isometric view of an object is shown in Figure Q1. Using first angle projection, draw its

- a) Sectional view AA front view (9 marks)
- b) Sectional view BB top view and (10 marks)
- c) Right side view (6 marks)

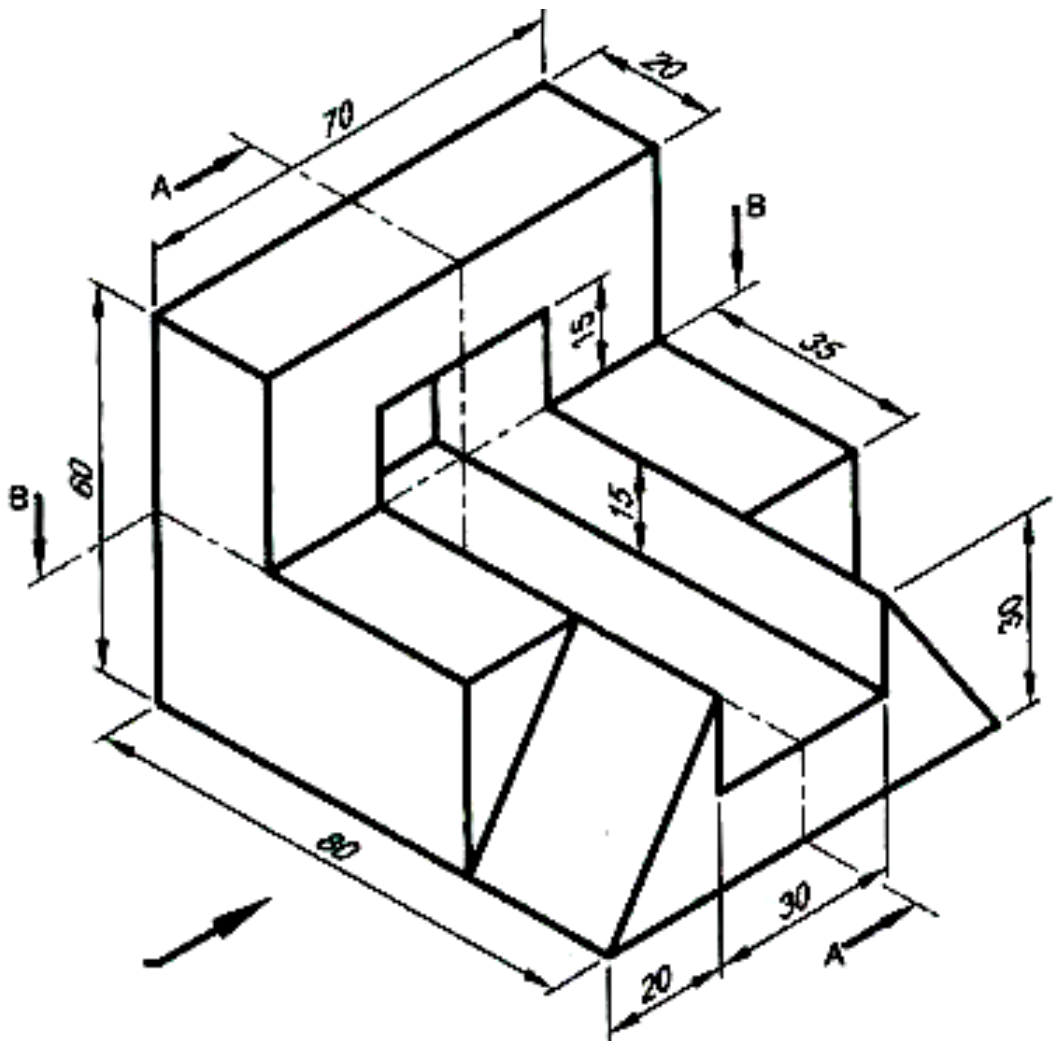

Figure Q1

Question 2

Figure Q2 is presented in 3rd angle projection. Draw in 3rd angle projection of the given views and right end view.

(25 marks)

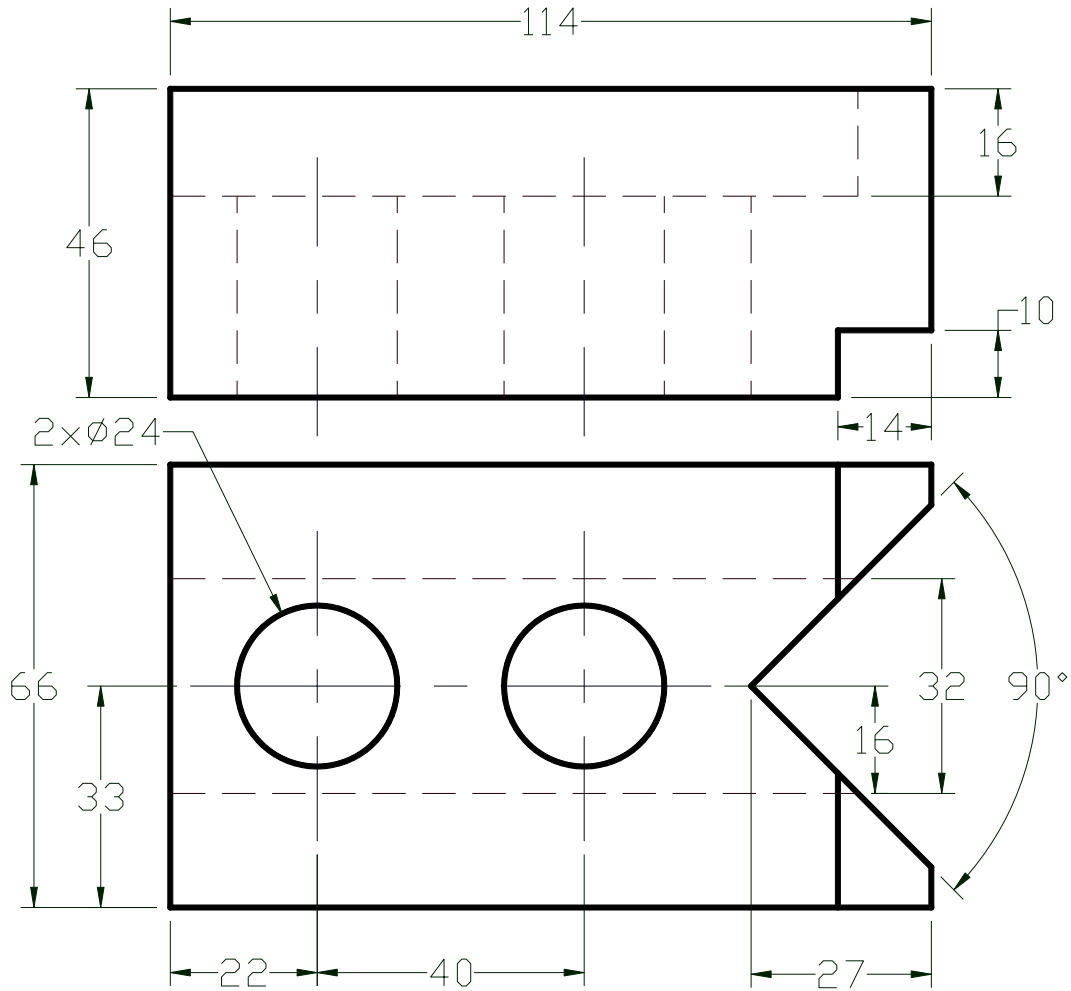

Figure Q2

Question 3

The component in Figure Q3 has been drawn in 3rd angle projection. Draw an isometric view of this component with the corner shown by the letter **A** in the foreground.

(25 marks)

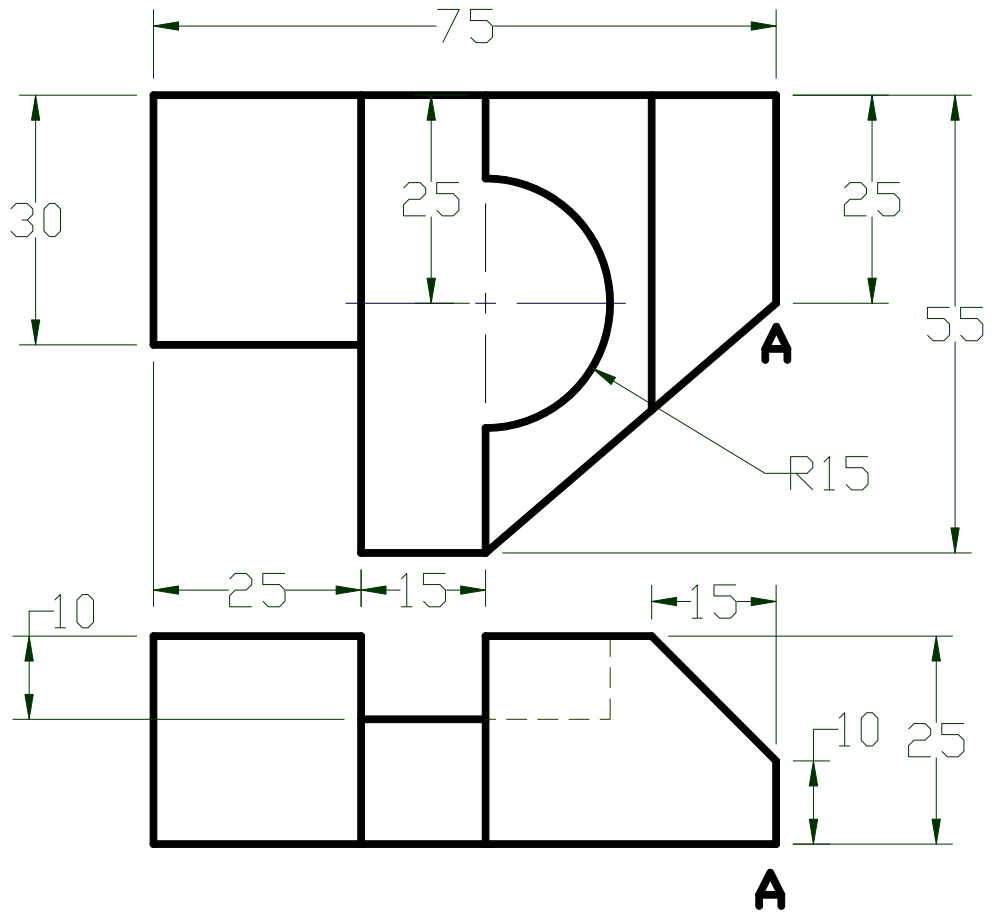

Figure Q3

Question 4

Two views of cut cylinder are shown in Figure Q4. Redraw the views and develop its lateral surface start from joint **XX**.

(25 marks)

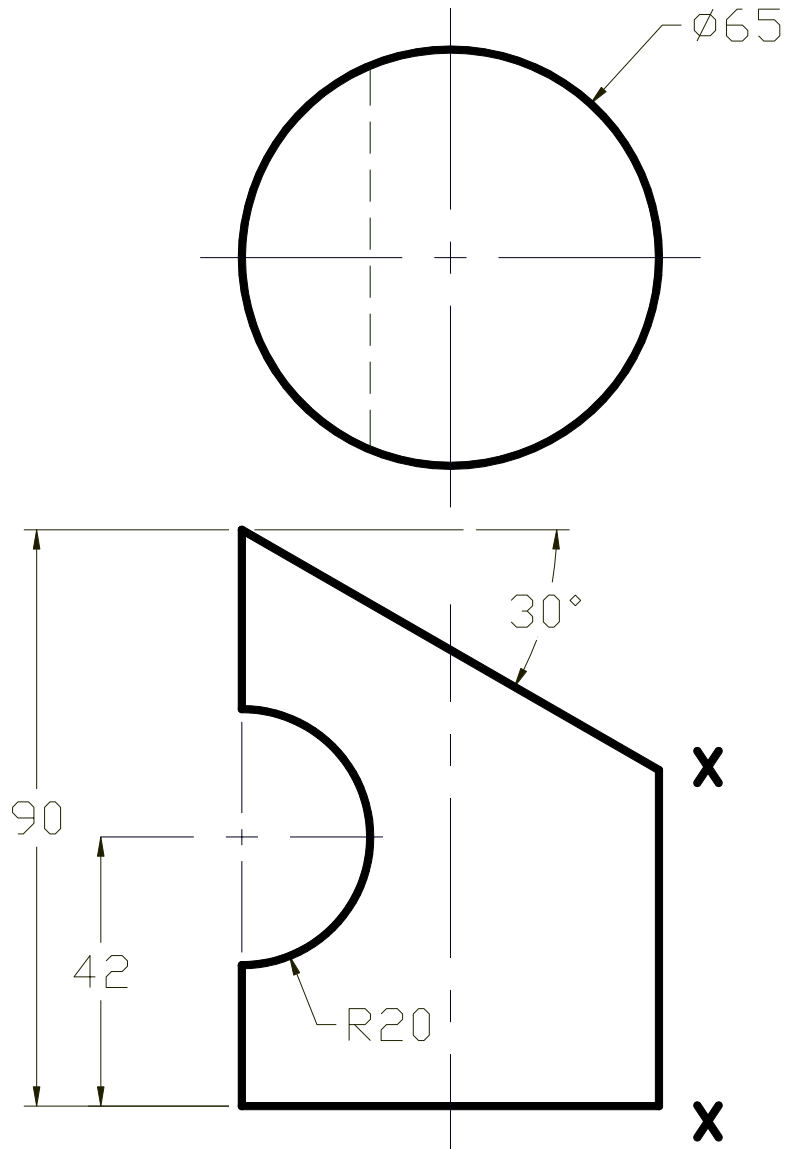

Figure Q4

-The End-